

County of Santa Clara
California

September 14, 1979

APPROVED BY THE BOARD OF SUPERVISORS
OF SANTA CLARA COUNTY SEP 17 1979
DONALD M. RAINS, Clerk of the Board
BY Beverly Fogle
Deputy Clerk

Honorable Board of Supervisors
Santa Clara County Transit District
County Government Center-East Wing
70 West Hedding Street
San Jose, California 95110

Subject: Amendment to the Almaden Expressway Agreement to add a
Temporary Median Opening at the Existing McIntosh Creek
Drive

Gentlepersons:

At the regular meeting of the Transportation Commission held Wednesday, September 12, 1979 it was unanimously recommended that the Transit District Board approve the recommendation of the Highways, Bikeways and Airports Committee to grant request of the City of San Jose for a temporary median opening in Almaden Expressway provided:

1. The median opening will be temporary in nature only and will be closed when Calcaterra Drive is extended north to Via Valiente Drive.
2. The median opening and subsequent median opening removal will be constructed at no cost to the County.
3. The design of the median opening will be subject to the Transportation Agency staff's approval.

A copy of the Highways, Bikeways and Airports Committee report to the Commission is attached for your convenience.

Yours truly,

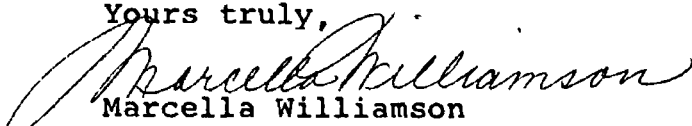
Marcella Williamson
Secretary

Ⓢ A/C Transp Agency

HIGHWAYS, BIKEWAYS AND AIRPORTS COMMITTEE REPORT
TO THE
TRANSPORTATION COMMISSION

Subject: Amendment to the Almaden Expressway Agreement
To Add A Temporary Median Opening At The
Existing McIntosh Creek Drive

Members Present: Cude, Fletcher, Winckler (Chairperson)

Members Absent: Heiman, Million

Introduction:

The Committee met on Wednesday, August 8, 1979 to discuss the request from the City of San Jose to amend the Almaden Expressway Agreement (between the City and the County) in order to add a temporary median opening at the existing McIntosh Creek Drive intersection (right turns only). Requests for modification of existing expressway agreements are considered to be "Special Requests Regarding the County Expressway Policy Resolution". The procedure for processing these requests requires the Highways, Bikeways and Airports Committee and the County Transportation Commission to review each request prior to consideration by the County Board of Supervisors.

Background

The original letter or request from the City of San Jose was submitted on April 24, 1979. The required technical data (detailed traffic analysis) was submitted by letter dated August 2, 1979. (Copies of these letters are attached.)

County staff prepared a report in response to the City's request. A copy of that report, dated August 6, 1979 is also attached.

Analysis:

The County Expressway Policy Resolution's requirement for new public street locations with median openings is $\frac{1}{2}$ mile or 2,600 feet. This request does not meet this standard since the distance between the proposed median opening and Via Valiente is about 1,500 feet.

In view of the nature of this request (temporary median opening to mitigate an existing safety situation), County staff recommends that this request be approved.

Discussion:

The Committee and City of San Jose's staff are in agreement with the County's proposed conditions of approval.

Recommendation

It is recommended that the County Transportation Commission approve the City of San Jose's request to install a temporary median opening in Almaden Expressway at the existing McIntosh Creek Drive intersection - provided the following conditions are agreed to by the City of

✓ all rec'd 8-21

BOARD OF SUPERVISORS
COUNTY OF
AUG 21 11 30 AM '79
SANTA CLARA

San Jose - and be forwarded to the County Board of Supervisors for similar action:

1. The median opening will be temporary in nature only and will be closed when Calcaterra Drive is extended north to Via Valiente Drive.
2. The median opening and subsequent median opening removal will be constructed at no cost to the County.
3. The design of the median opening will be subject to the Transportation Agency staff's approval.

Submitted by:

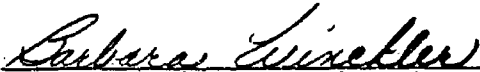

Barbara Winckler (Chairmember)

attachments

cc: Each Member of the Highways, Bikeways and Airports Committee
Each Member of the Board of Supervisors
William Siegel
Clerk of the Board of Supervisors
D. Kent Dewell, City of San Jose
Joseph Bass, City of San Jose
JHG
LM
RMS
JYT

August 6, 1979

REPORT TO THE
HIGHWAYS, BIKEWAYS AND AIRPORTS COMMITTEE

Subject: Amendment to the Almaden Expressway Agreement
To Add A Temporary Median Opening At The
Existing McIntosh Creek Drive

Introduction:

The City of San Jose has officially requested the County to amend the Almaden Expressway Agreement (between the City and the County) in order to add a temporary median opening at the existing McIntosh Creek Drive intersection (right turns only). Requests for modification of existing expressway agreements are considered to be "Special Requests Regarding the County Expressway Policy Resolution". The procedure for processing these requests requires the Highways, Bikeways and Airports Committee and the County Transportation Commission to review each request prior to the consideration by the County Board of Supervisors.

Background:

The original letter of request from the City of San Jose was submitted on April 24, 1979. The required technical data (detailed traffic analysis) was submitted by letter dated August 2, 1979. A copy of these letters is attached.

Specific Request:

The Orchard Creek Subdivision off Almaden Expressway, south of Via Valiente, was allowed to develop without proper long-term access to the Expressway-Major Street Traffic Circulation System. It was thought that subsequent developments adjacent to this subdivision would include the dedication and improvement of City streets that would correct this deficiency. Unfortunately, this "interim" situation has existed for about five years. The existing situation is shown on Exhibit "X".

The City is proposing to correct this safety situation by installing - at no cost to the County - a temporary median opening in the expressway that would allow left turns in and out of the Orchard Creek Subdivision. The proposed temporary situation is shown on Exhibit "Y".

At such time as the adjacent property does develop, access to the Major Street Circulation System (Calcaterra Drive and Via Valiente) will be achieved, and the temporary median opening will be removed at no cost to the County. This ultimate situation is shown on Exhibit "Z".

Analysis

The County Expressway Policy Resolution's requirement for new public street locations with median openings is $\frac{1}{2}$ mile or 2,600 feet. This request does not meet this standard since the distance between the proposed median opening and Via Valiente is about 1,500 feet.

In view of the nature of this request (temporary median opening to mitigate an existing safety situation), County staff recommends that this request be approved.

Recommendation

It is recommended that the Highways, Bikeways and Airports Committee approve the City of San Jose's request to install a temporary median opening in Almaden Expressway at the existing McIntosh Creek Drive intersection - provided the following conditions are agreed to by the City of San Jose - and be forwarded to the County Transportation Commission and to the County Board of Supervisors for similar action:

1. The median opening will be temporary in nature only and will be closed when Calcaterra Drive is extended north to Via Valiente Drive.
2. The median opening and subsequent median opening removal will be constructed at no cost to the County.
3. The design of the median opening will be subject to the Transportation Agency staff's approval.

Submitted by:

SCOTTY A. BRUCE
Staff Liaison

SAB:vlt

cc: Each Member of the Highways, Bikeways and Airports Committee
Each Member of the Board of Supervisors
William Siegel
Clerk of the Board of Supervisors
D. Kent Dewell, City of San Jose
Joseph Bass, City of San Jose
JHG
LM
RMS
JYT

EXISTING CONDITION
EXHIBIT "X"

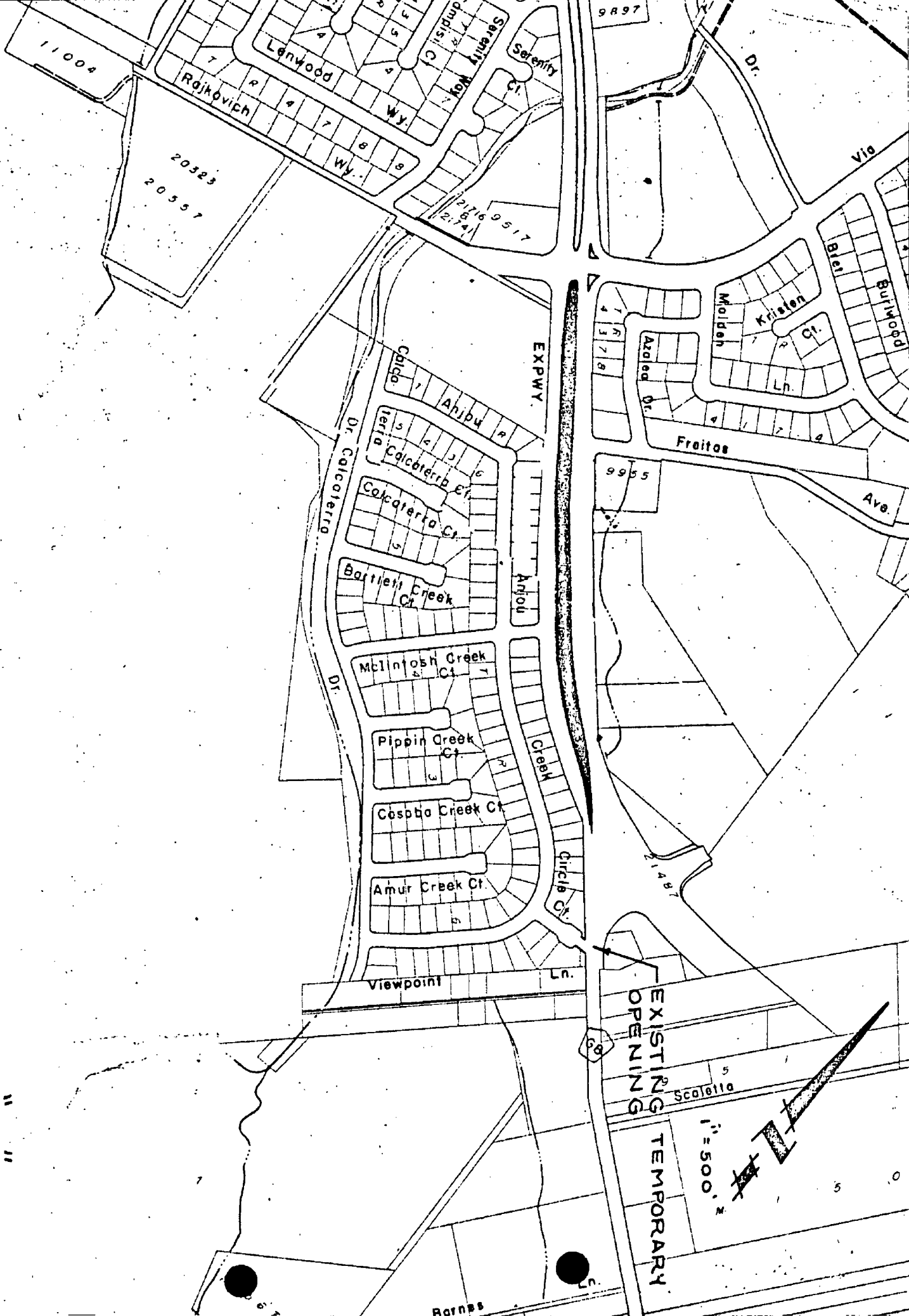

PROPOSED TEMPORARY OPENING
EXHIBIT "Y"
PROPOSED TEMPORARY OPENING

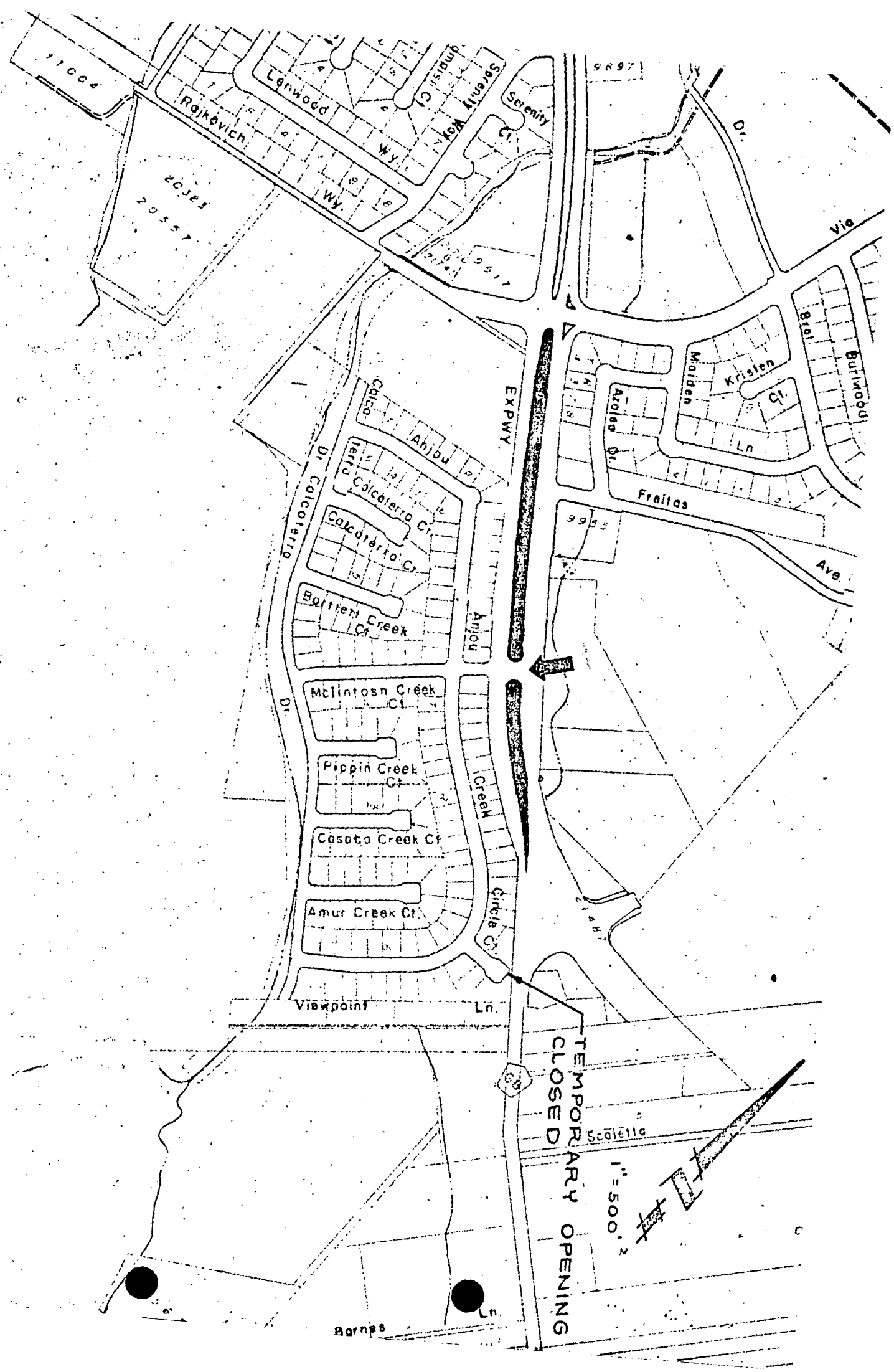
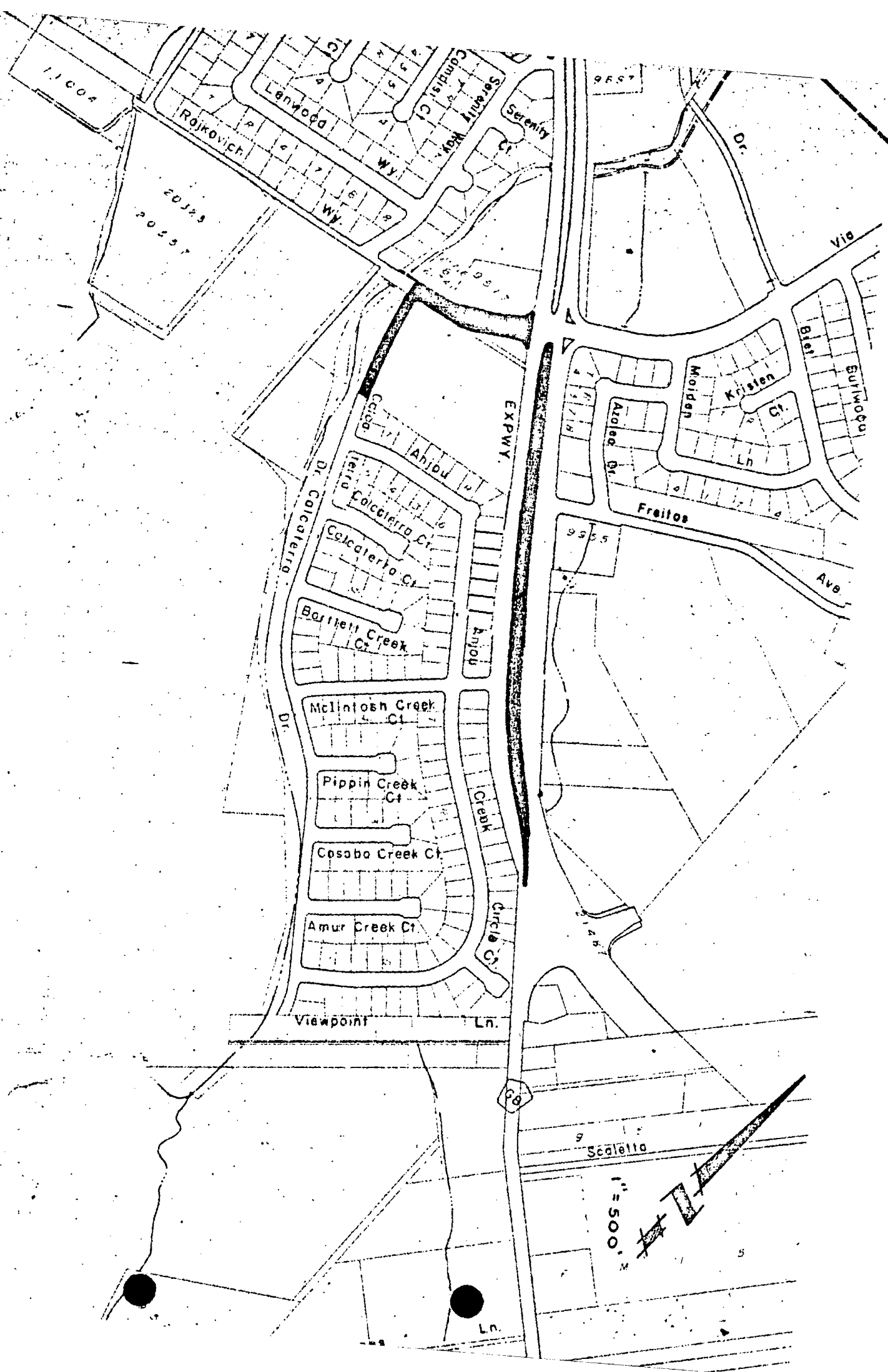
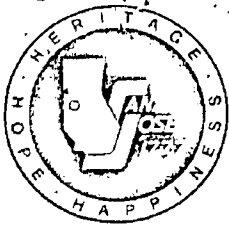

EXHIBIT "Z"
ULTIMATE CONDITION





CITY OF SAN JOSE, CALIFORNIA

801 NORTH FIRST STREET
SAN JOSE, CA 95110
(408) 277-4000

DEPARTMENT OF PUBLIC WORKS

April 24, 1979

Mr. James Graebner
District Director
Transportation Agency
County of Santa Clara
1555 Berger Drive
San Jose, California 95112

Attention: Mr. Lou Montini

Dear Mr. Graebner:

SUBJECT: ALMADEN EXPRESSWAY AND McINTOSH CREEK DRIVE

The City of San Jose requests a temporary median opening on Almaden Expressway at McIntosh Creek Drive to allow full access with appropriate left turn lanes, accel/de-accel lanes and no signalization. At present, only right turns in and out are allowed at this intersection.

The requested opening is proposed in order to eliminate a serious problem at Anjou Creek Court and the Expressway. This intersection is on the two-lane portion of Almaden Road and has no left turn pockets or accel/de-accel lanes and, coupled with the relatively high speeds on Almaden Road, makes for a hazardous situation. The requested opening would make it possible to close the Anjou Creek Court access to the Expressway.

The temporary median opening would, by mutual agreement, be closed when Calcaterra Drive is extended to Via Valiente. Construction of Calcaterra Drive would provide the area with access to Almaden Expressway at a signalized intersection and would eliminate the need for the temporary opening.

We expect Calcaterra Drive to be extended to Via Valiente within the next three years; at which time the median opening at McIntosh Creek Drive would be closed.

If you have any questions, or desire any additional information, please contact Mr. Joseph Bass at 277-5161.

Very truly yours,

A. R. TURTURICI
Director of Public Works

DKD:JFB:sb

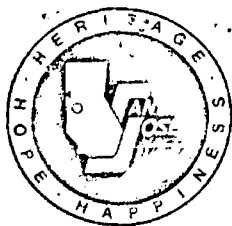

CITY OF SAN JOSE, CALIFORNIA

801 NORTH FIRST STREET
SAN JOSE, CA 95110
(408) 277-4000

DEPARTMENT OF PUBLIC WORKS
A. R. TURTURICI, DIRECTOR

August 2, 1979

Mr. James Graebner, District Director
Transportation Agency
County of Santa Clara
1555 Berger Drive
Santa Clara, Ca 95112

Attn: Mr. Scotty Bruce

Dear Mr. Graebner:

Subject: Temporary Median Opening on Almaden Expressway at McIntosh
Creek Drive - Report Format For Highways, Bikeways Committee
Meeting, August 8, 1979

BACKGROUND:

In response to your letter of June 5, 1979, we are hereby submitting additional information concerning a temporary median opening on Almaden Expressway at McIntosh Creek Drive.

The Orchard Creek Subdivision off Almaden Expressway, south of Via Valiente, has access to the expressway at McIntosh Creek Drive and Anjou Creek Court (see attached Diagram A). The McIntosh Drive access is right turns in and out only, while full access with left turns in and out is available at the Anjou Creek Court intersection. The Anjou Creek Court intersection occurs on the two-lane portion of Almaden Road (one lane north and one lane south) and has no separate left-turn lane, accel or de-accel lanes. This intersection was allowed on a temporary basis since no other left-turn lane in or out of the site is available. Anjou Creek Court will ultimately be closed and converted into a cul-de-sac street for which it was originally planned.

ANALYSIS:

The latest traffic volume counts available in this area updated by a 3% per year growth factor indicates an ADT of approximately 8,800 vehicles, or approximately 880 vehicles during the peak hours immediately south of Via Valiente. Utilizing a 70% northbound and 30% southbound percentage split during the AM peak hour, (which is the most critical period because of the necessary left-turns to exit the subdivision to head north) this means approximately 620 vehicles are heading north and 260 are heading south.

The Orchard Creek Subdivision generates approximately 2,000 vehicle trips per day, 200 during the peak hour and using the same percentage for directional split, 140 vehicles northbound - almost 25% of the total northbound traffic.

Because almost all of the outbound AM traffic leaving the Orchard Creek Subdivision would be traveling north, it is necessary for these vehicles to egress the subdivision via the Anjou Creek Court intersection or to make illegal left-turns or U-turns across the expressway dirt median, which, evidence indicates, some motorists choose to do.

A speed study conducted by the City of San Jose in October, 1978, on Almaden Road between McIntosh Creek Drive and McKean Road, showed an eighty-five percentile speed of 47 mph. This speed, coupled with the lack of any channelization, left-turn storage lanes or accel, de-accel lanes for ingress or egress at Anjou Creek Court, creates a potentially hazardous situation for all vehicles concerned.

The ultimate plan for circulation in this area shows Calcaterra Drive to be extended to Via Valiente Drive which has a signalized intersection with Almaden Expressway. There are no public funds for this road extension, and its construction will depend upon funding from adjacent developers.

In order to alleviate this problem, residents of the Orchard Creek Subdivision have requested that a temporary median opening be constructed on Almaden Expressway opposite McIntosh Creek Drive.

A review of the geometrics of the Almaden Expressway/McIntosh Creek Drive intersection (see attached Diagram B), indicates that the request for a temporary median opening is an appropriate proposal and an altogether reasonable interim solution to the problem at hand for the following reasons:

1. There are two lanes northbound on the expressway at this point which dilutes the effect of the traffic volumes on the expressway, thereby providing more opportunity for crossing southbound traffic and merging with northbound traffic.
2. The wide dirt median provides ample space to construct safe left-turn storage lanes for both ingress and egress traffic to McIntosh Creek Drive.
3. Accel and de-accel lanes are presently existing on the expressway at this location.
4. The developer of the Cheim property, which lies south of the Orchard Creek Subdivision, has agreed to finance the cost for the construction of the temporary median opening at McIntosh Creek Drive.

Mr. James Graebner, District Director
Attn: Mr. Scotty Bruce

8-2-79
Page 3

RECOMMENDATION:

Based on the above analysis, we recommend and hereby request that a temporary median opening on Almaden Expressway be allowed at McIntosh Creek Drive with the following conditions:

1. The median opening will be temporary in nature only, and will be closed when Calcaterra Drive is extended north to Via Valiente Drive.
2. The median opening will be constructed at no cost to the County.
3. The design of the median opening will be subject to the Transportation Agency staff's approval.

If you have any questions on this matter, please contact Joseph Bass of my staff at 277-5161.

Very truly yours,

A. R. TURTURICI
Director of Public Works

DKD:JFB:tb
Attachments

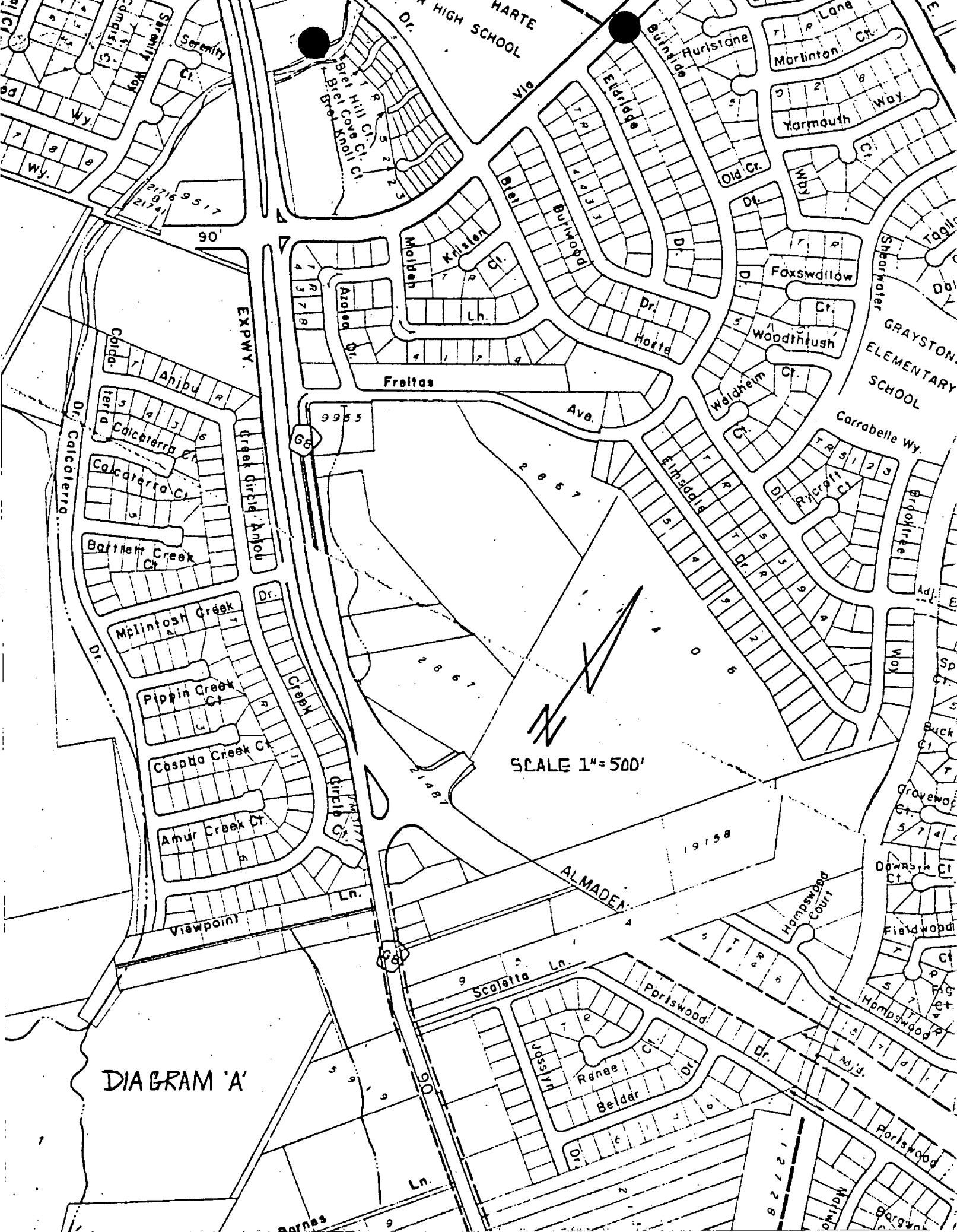
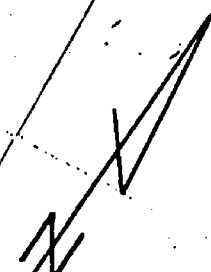
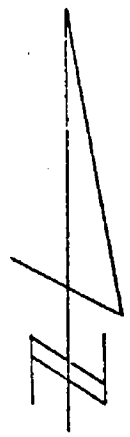

DIAGRAM 'A'

SCALE 1" = 500'





SCALE: 1" = 200'

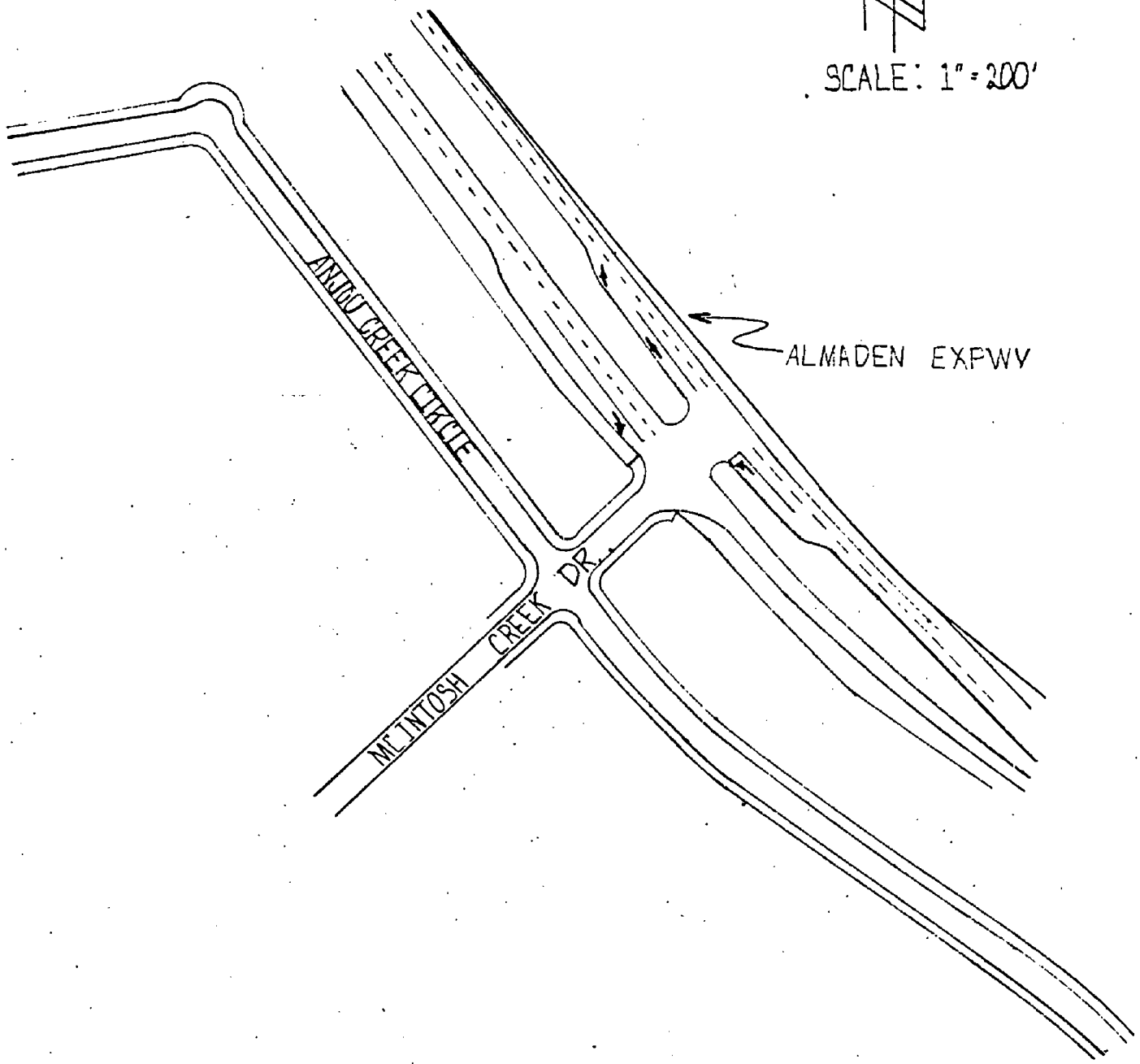

DIAGRAM 'B'